

### DEF Standard 59-96 (NATO Reference System)

	Part No.	Current Rating	Body Size	Rated Voltage (ac)	Fixing Centres (mm)	Interrupting Rating	Box Quantity
	059-0107	0.25	0	440	-	33 kA @ 440 Vac	10 pcs
	059-0108	0.5					
	059-0109	1					
	059-0110	2					
	059-0111	3					
	059-0112	5					
	059-0113	7					
	011-9925	10					
	059-0140	0.5	1	440	-	33 kA @ 440 Vac	25 pcs
	059-0141	1					
	059-0142	2					
	059-0143	3					
	059-0144	5					
	059-0145	7					
	059-0146	10					
	059-0147	15					
011-9483	20						
	059-0114	0.5	1	440	44.65	33 kA @ 440 Vac	25 pcs
	059-0115	1					
	059-0116	2					
	059-0117	3					
	059-0118	5					
	059-0119	7					
	059-0120	10					
	059-0121	15					
011-9679	20						
	059-0148	10	2	440	-	33 kA @ 440 Vac	25 pcs
	059-0149	15					
	059-0150	20					
	059-0122	10	2	440	55.84	33 kA @ 440 Vac	25 pcs
	059-0123	15					
	059-0124	20					
	059-0125	30					
	012-0067	40					
	011-9127	50					
	012-0140	30	3	440	-	33 kA @ 440 Vac	25 pcs
	059-0151	30					
	059-0152	40					
	059-0153	60					
	059-0154	80	3	440	69.77	33 kA @ 440 Vac	25 pcs
	059-0155	100					
	059-0126	40					
	059-0127	60					
	059-0128	80					
	059-0129	100					
011-9128	125						
011-9129	150						

**Dimensional Data for Joint Service Fuse Links**

**Cylindrical (Cyl)**

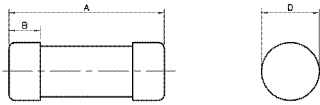

**Offset Bolted Tag (O.B.T.)**

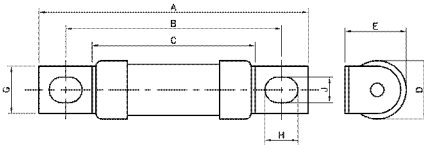

Part No	Current Rating	Body Size	Tag Type	A	B	C	D	E							
059-0107	0.25	0	Cyl.	32.05	-	-	6.37	5.55							
059-0108	0.5														
059-0109	1														
059-0110	2														
059-0111	3														
059-0112	5														
059-0113	7														
011-9925	10														
011-9926	15														
059-0140	0.5								1	Cyl.	33.6	-	-	11.86	7.14
059-0141	1														
059-0142	2														
059-0143	3														
059-0144	5														
059-0145	7														
059-0146	10														
059-0147	15														
011-9483	20														
059-0114	0.5	1	Offset Bolted Tag	56.03	44.65	33.9	11.96	-							
059-0115	1														
059-0116	2														
059-0117	3														
059-0118	5														
059-0119	7														
059-0120	10														
059-0121	15														
011-9679	20														
012-0140	30														
059-0148	10								2	Cyl.	37.6	-	-	16.7	8.71
059-0149	15														
059-0150	20														
059-0151	30														
059-0122	10	2	Offset Bolted Tag	70.7	55.84	37.4	16.7	-							
059-0123	15														
059-0124	20														
059-0125	30														
012-0067	40														
011-9127	50														
012-0141	60														
059-0152	40	3	Cyl.	47.9	-	-	33.3	11.9							
059-0153	60														
059-0154	80														
059-0155	100														
059-0126	40	3	Offset Bolted Tag	88.6	69.77	47.4	33.3	-							
059-0127	60														
059-0128	80														
059-0129	100														
011-9128	125														
011-9129	150														