

Neozed

1002704
1002804
1002904

400VAC/250VDC
 fast, (gG)
 D01, D02, D03



Class gG for cable and line protection

1002704 & 1002904 BOTTLE NECK DIMENSIONS			
	AMPS	A	B
D01 (E14)	1-16A	36	11
D02 (E18)	20-63A	36	15
D03 (M30x2)	80-100A	43	24

PART NO.	SIZE	AMP	INDICATOR
1002704-1	D01	1A	-
1002704-2	D01	2A	PINK
1002704-4	D01	4A	BROWN
1002704-6	D01	6A	GREEN
1002704-10	D01	10A	RED
1002704-16	D01	16A	GREY
1002804-20	D02	20A	BLUE
1002804-25	D02	25A	YELLOW
1002804-35	D02	35A	BLACK
1002804-50	D02	50A	WHITE
1002804-63	D02	63A	COPPER
1002904-80	D03	80A	SILVER
1002904-100	D03	100A	RED



1002707
1002807
1002907

440VAC
 ultra rapid (gR)
 D01, D02, D03



Class gR for semiconductor protection

1002707, 1002807 & 1002907 BOTTLE NECK DIMENSIONS			
	AMPS	A	B
D01 (E14)	1-16A	36	11
D02 (E18)	20-63A	36	15
D03 (M30x2)	80-100A	43	24

PART NO.	SIZE	AMP	INDICATOR
1002707-2	D01	2A	PINK
1002707-4	D01	4A	BROWN
1002707-6	D01	6A	GREEN
1002707-10	D01	10A	RED
1002707-16	D01	16A	GREY
1002807-20	D02	20A	BLUE
1002807-25	D02	25A	YELLOW
1002807-35	D02	35A	BLACK
1002807-50	D02	50A	WHITE
1002807-63	D02	63A	COPPER
1002907-80	D03	80A	SILVER
1002907-100	D03	100A	RED

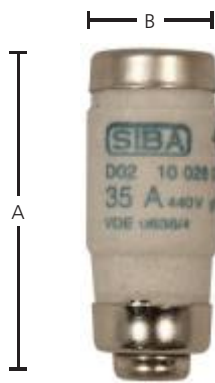

Miscellaneous

RL1



380VAC

Chinese standard



Fast acting for general applications (Usually found in Chinese equipment).

PLEASE NOTE: Dimensions can vary by up to 3mm.

PART NO.	AMP
RL1-2	2A
RL1-4	4A
RL1-6	6A

PART NO.	AMP
RL1-10	10A
RL1-15	15A

BLA



600VAC/DC

Japanese standard

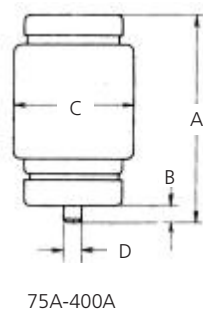
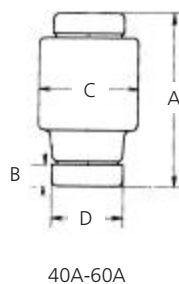
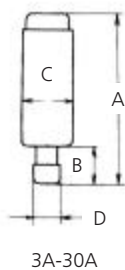

Fast acting for general applications

PART NO.	AMP	INDICATOR	A (mm)	B (mm)	C (mm)	D (mm)
BLA-3	3A	PINK	50	10	13	8
BLA-5	5A	BROWN	50	10	13	8
BLA-10	10A	RED	50	10	13	8
BLA-15	15A	GREY	50	10	13	10
BLA-20	20A	BLUE	50	10	13	10
BLA-30	30A	VIOLET	50	10	13	14
BLA-40	40A	BLACK	50	10	27	16
BLA-60	60A	LIGHT RED	50	10	27	20
BLA-75	75A	SILVER	63	5.4	34	5
BLA-100	100A	RED	63	5.4	34	8
BLA-125	125A	YELLOW	63	5.4	47	5
BLA-150	150A	LIGHT RED	63	5.4	47	8
BLA-200	200A	BLUE	63	5.4	47	10
BLA-250	250A	GREEN	63	5.4	61	5
BLA-300	300A	WHITE	63	5.4	61	8
BLA-400	400A	BLACK	63	5.4	61	10

Automotive

MINI 32VDC



Fast acting for general DC applications

← 11mm →



PART NO.	AMP	COLOUR
MINI-2	2A	GREY
MINI-3	3A	VIOLET
MINI-4	4A	PINK
MINI-5	5A	TAN
MINI-7.5	7.5A	BROWN

PART NO.	AMP	COLOUR
MINI-10	10A	RED
MINI-15	15A	BLUE
MINI-20	20A	YELLOW
MINI-25	25A	CLEAR
MINI-30	30A	GREEN

AUTO 32VDC

Fast acting for general DC applications

← 19mm →



PART NO.	AMP	COLOUR
AUTO-1	1A	BLACK
AUTO-2	2A	GREY
AUTO-3	3A	VIOLET
AUTO-4	4A	PINK
AUTO-5	5A	TAN
AUTO-7.5	7.5A	BROWN
AUTO-10	10A	RED

PART NO.	AMP	COLOUR
AUTO-15	15A	BLUE
AUTO-20	20A	YELLOW
AUTO-25	25A	CLEAR
AUTO-30	30A	GREEN
AUTO-35	35A	BLUE/GREEN
AUTO-40	40A	ORANGE

MAXI 32VDC



Slow (time delay) for general DC applications

← 29mm →



PART NO.	AMP	COLOUR
MAXI-20	20A	YELLOW
MAXI-25	25A	GREY
MAXI-30	30A	GREEN
MAXI-35	35A	BROWN
MAXI-40	40A	ORANGE

PART NO.	AMP	COLOUR
MAXI-50	50A	RED
MAXI-60	60A	BLUE
MAXI-70	70A	TAN
MAXI-80	80A	CLEAR

Auto Fuses Holders

FHA7-20 in-line holder for MINI fuse

20A 32VDC rated in-line fuse holder with splash proof cover



FHA5-20 in-line holder for AUTO fuse

20A 32VDC rated in-line fuse holder with splash proof cover



FHA6-80 in-line holder for MAXI fuse

80A 32VDC rated in-line fuse holder with splash proof cover



FUSECO

DC Voltage

MIDI
32VDC
slow



Slow acting for DC applications

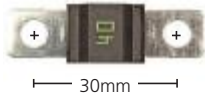

PART NO.	AMP	COLOUR
MIDI-40	40A	GREEN
MIDI-50	50A	RED
MIDI-60	60A	YELLOW
MIDI-70	70A	BROWN

PART NO.	AMP	COLOUR
MIDI-80	80A	WHITE
MIDI-100	100A	BLUE
MIDI-125	125A	ORANGE
MIDI-150	150A	GREY

FUSE HOLDERS TO SUIT **See Below**

MEGA
32VDC
slow



Slow acting for DC applications

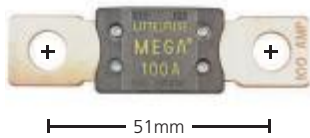

PART NO.	AMP	COLOUR
MEGA-60	60A	-
MEGA-80	80A	RED
MEGA-100	100A	YELLOW
MEGA-125	125A	GREEN
MEGA-150	150A	ORANGE

PART NO.	AMP	COLOUR
MEGA-175	175A	WHITE
MEGA-200	200A	BLUE
MEGA-225	225A	TAN
MEGA-250	250A	PINK

FUSE HOLDERS TO SUIT **See Below**

DC Fuse Holders

498900
holder for MIDI fuse
32VDC rated fuse holder



298-1001
holder for MEGA fuse
Single assembly fuse holder.
Also available in dual and triple assembly

